

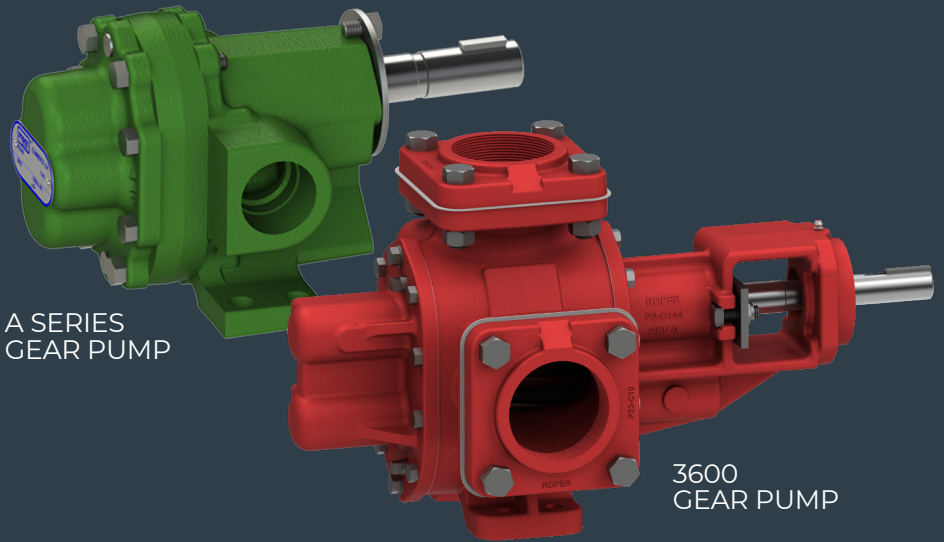

THE LEADING FORCE behind liquids™ since 1857

Ink Pumps



A SERIES GEAR PUMP

3600 GEAR PUMP

Roper Pump's quiet, smooth-running ink pumps are specially designed to suit the unique needs of the ink market.

Depending on viscosities, the A series pump may operate up to standard motor speeds. The 3600 series may operate up to 700 RPM.

Each Roper ink pump is manufactured to close tolerances, then tested to ensure dependable performance. These self-priming pumps are factory assembled for clockwise rotation, but may be reassembled for equally efficient operation in a counter-clockwise rotation.

The Roper ink pump is equipped with PTFE packing and iron bearings. The internal bearings are lubricated by the fluid being pumped. The PTFE packing, in combination with low discharge pressure and slow speed greatly reduces the tendency for the ink pigment to dry out.

To find out more about the Roper ink pump, contact Roper Pump company or your local distributor.

Materials of Construction

A Series

- Cast iron housings (ductile iron available)
- Hardened steel gears
- Hardened steel shafts
- Bronze bearings (iron / carbon available)

3600 Series

- Cast iron housings (ductile iron* available)
- Hardened iron alloy gears (bronze / stainless steel* available)
- Steel shafts (stainless steel available)
- Bronze bearings (iron / carbon available)

*Not available for all sizes.

Advantages

- PTFE packing and iron bearings.
- Available relief valve helps to protect pump from excessive outlet pressure.
- Mechanical seal is available upon request. Consult the factory.

PERFORMANCE CHARTS

A Series

SIZE	RPM		3600 RPM				1800 RPM				1200 RPM				900 RPM				720 RPM			
	PSI	SSU	30	100	1000	5000	30	100	1000	5000	30	100	1000	10,000	30	100	1000	10,000	30	100	1000	10,000
005	50	GPM HP	1.62 .41	1.78 .32	1.83 .53	1.83 .84	.70 .17	.87 .14	.91 .21	.91 .34	.39 .06	.56 .06	.61 .13	.61 .21	.24 .05	.41 .05	.45 .09	.45 .15	.15 .04	.32 .04	.36 .06	.36 .12
	100	GPM HP	1.30 .80	1.71 .47	1.83 .64	1.83 .95	.38 .33	.79 .21	.91 .26	.91 .39		.48 .10	.61 .15	.61 .24		.33 .08	.45 .11	.45 .18		.24 .06	.36 .09	.36 .14
03	50	GPM HP	10.42 .70	11.5 .68	11.41 .94	11.49 1.29	4.66 .34	5.29 .33	5.65 .45	5.73 .62	2.74 .20	3.37 .20	3.73 .29	3.82 .46	1.78 .15	2.41 .15	2.77 .21	2.86 .34	1.20 .12	1.83 .12	2.19 .17	2.28 .27
	100	GPM HP	9.3 1.6	10.0 1.6	11.32	11.45 1.96	3.66 .85	4.83 .68	5.56 .77	5.69 .94		2.91 .41	3.64 .50	3.80 .67		1.95 .31	2.68 .37	2.84 .50		1.37 .25	2.10 .30	2.26 .40

SIZE	RPM		1800 RPM				1200 RPM				900 RPM					720 RPM				
	PSI	SSU	30	100	1000	5000	30	100	1000	5000	30	100	1000	5000	10,000	30	100	1000	5000	10,000
06	50	GPM HP	10.6 .88	10.9 .88	11.2 1.33	11.2 2.08	6.8 .48	7.1 .48	7.4 .7	7.5 1.04	4.9 .34	5.2 .34	5.5 .49	5.6 .71	5.6 .85	3.8 .25	4.1 .25	4.4 .35	4.4 .48	4.5 .57
	100	GPM HP	9.8 1.21	10.40 1.21	11.0 1.66	11.1 2.41	6.0 .7	6.7 .7	7.2 .92	7.4 1.26	4.1 .5	4.8 .5	5.3 .65	5.5 .87	5.5 1.01		3.6 .38	4.2 .48	4.4 .61	4.4 .7
16	50	GPM HP	27.8 2.1	29.2 2.3	30.4 2.6	30.8 3.4	17.4 1.2	18.8 1.3	20.1 1.4	20.4 1.8	12.2 .8	13.6 .8	14.9 1.0	15.2 1.3	15.3 1.5	9.1 .6	10.5 .6	11.8 .7	12.1 1.0	12.2 1.1
	100	GPM HP	25.7 3.0	28.0 3.2	30.0 3.5	30.6 4.3		17.6 1.9	19.6 2.0	20.2 2.4		12.4 1.3	14.4 1.4	15.0 1.8	15.2 2.0		9.3 1.0	11.3 1.1	11.9 1.3	12.1 1.5
32	50	GPM HP	50.8 3.9	54.3 3.9	57.6 4.1	58.5 5.7	31.0 2.3	34.5 2.3	37.8 2.5	38.7 3.4		24.6 1.7	27.9 1.8	28.8 2.5	29.1 2.9		18.7 1.3	22.0 1.4	22.9 1.9	23.1 2.2
	100	GPM HP		51.8 5.6	56.7 5.8	58.1 7.5		32.0 3.5	36.9 3.7	38.3 4.6		22.1 2.5	27.0 2.7	28.4 3.3	28.8 3.7			21.1 2.1	22.4 2.6	22.8 2.9

An outboard ball bearing is recommended for viscosities below 40 SSU on A06 through A40. Additional sizes available.

3600 Series

SIZE	RPM		300 RPM				400 RPM				500 RPM				600 RPM				700 RPM			
	PSI	SSU	30	100	1000	10,000	30	100	1000	10,000	30	100	1000	10,000	30	100	1000	10,000	30	100	1000	10,000
3611 4611	25	GPM HP	31 .9	32 .9	33 1.1	33 1.7	42 1.2	43 1.2	44 1.6		53 1.6	54 1.6	55 2.4		64 2.1	65 2.1	66 2.9		75 2.5	75 2.5	77 3.5	
	50	GPM HP	29 1.3	31 1.3	33 1.5	33 2.1	40 1.9	42 1.9	44 2.3		51 2.4	53 2.4	55 3.2		62 2.9	64 2.9	65 3.7		73 3.5	75 3.5	77 4.5	
	100	GPM HP		29 2.3	32 2.5	33 3.1		41 3.2	43 3.6			51 4.0	54 4.8			63 4.9	65 5.7			74 5.7	76 6.7	
3617 4617	25	GPM HP	46 1.0	49 1.0	50 1.4	51 2.3	63 1.4	66 1.4	67 2.1		80 2.0	83 2.0	84 3.0		95 2.7	100 2.7	101 4.1		115 3.3	117 3.3	118 5.3	
	50	GPM HP	42 1.7	47 1.7	50 2.1	51 3.0	59 2.4	64 2.4	67 3.1		76 3.2	81 3.2	84 4.2		93 4.1	98 4.1	101 5.5		111 5.0	115 5.0	118 7.0	
	100	GPM HP		43 3.1	49 3.5	50 4.4		60 4.3	66 5.0			77 5.6	83 6.6			94 7.0	100 8.4			111 8.4	117 10.4	
3622 4622	25	GPM HP	83 1.4	65 1.4	68 1.8	66 2.6	85 2.4	87 2.4	88 3.2		107 3.0	109 3.0	110 4.1		129 3.5	131 3.5	132 4.8		151 4.5	153 4.5	154 6.4	
	50	GPM HP	61 2.4	63 2.4	65 3.8	66 3.6	83 3.7	85 3.7	87 4.5		105 4.5	107 4.5	109 5.6		127 5.4	129 5.4	131 6.7		149 6.6	151 6.6	153 8.5	
	100	GPM HP		61 4.3	65 4.7	66 5.5		83 6.1	86 6.9			105 7.5	108 3.6			127 9.2	130 10.5			149 11.0	152 12.9	

